

WAFER TYPE BUTTERFLY VALVE MULTIPLE FLANGED

Model : ARV-112WT(U)

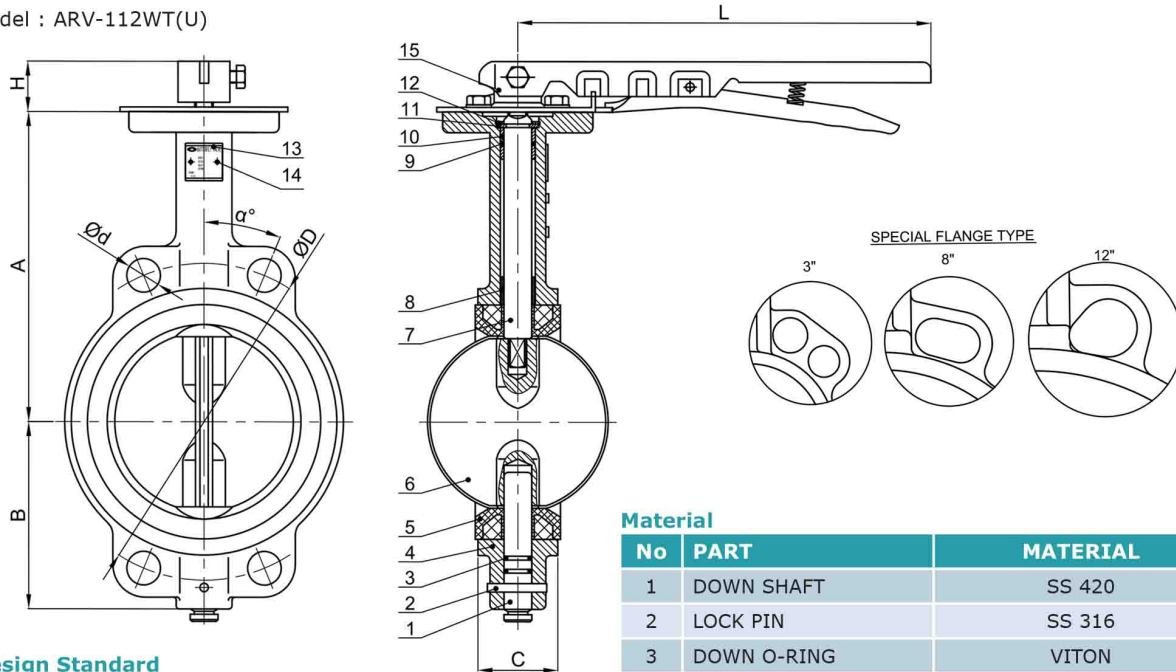

Design Standard

Design Standard	EN 593
Face to Face	EN 558
Flange Connection	Arita Universal Standard (include ANSI 150, JIS 10K, EN 1092 PN 10/16, AS 2129 Table E)
Test Standard	EN 12266-1

Hydrostatic Test

Pressure Rating	PN 10
Shell Test Pressure	1.5 Mpa
Seal Test Pressure	1.1 Mpa
Suitable Temperature	-20 to 180°C (PTFE)

Dimension in mm

DN	NPS	A	B	C	ØD	Ød	a°	H	L
40	1.5"	136	65	32	Ø105.6	Ø23	45°	33	200
50	2"	156	80	42.04	Ø120	Ø24	45°	33	200
65	2.5"	162	89	45.68	Ø136.13	Ø28	45°	33	200
80	3"	170	95	45.21	Ø154.5 Ø149.7	Ø24.5 Ø22	22.5° 45°	33	200
100	4"	185	119	52.07	Ø182.5	Ø27	22.5°	33	200
125	5"	207	127	55.36	Ø212.5	Ø25.5	22.5°	33	200
150	6"	216	139	55.76	Ø238.12	Ø26	22.5°	33	200
200	8"	256	175	60.58	Ø293 Ø296.07	Ø26 Ø27	15° 22.5°	40	373
250	10"	248	203	67.63	Ø357	Ø30.5	15°	40	373
300	12"	280	242	76.9	Ø400 Ø416.7	Ø25 Ø40.5	11.5° 15°	40	373

Material

No	PART	MATERIAL
1	DOWN SHAFT	SS 420
2	LOCK PIN	SS 316
3	DOWN O-RING	VITON
4	BODY	SS 316
5	SEAT	PTFE
6	DISC	SS 316
7	UPPER SHAFT	SS 420
8	BUSHING (LONG)	PTFE
9	O-RING	VITON
10	BUSHING (SHORT)	PTFE
11	BESECT RING	SS 416
12	KEEPING RING	SPRING STEEL
13	NAME PLATE	ALUMINIUM
14	RIVET	ALUMINIUM
15	HAND LEVER	STAINLESS STEEL

The contents of this literature are for informative purposes only. Arita is not responsible for suitability or compatibility of these products in relation to system requirement. For specific requirements, consult Arita or its distributors. Arita reserves the right to change or modify product design without prior notice.

WAFER TYPE BUTTERFLY VALVE MULTIPLE FLANGED

Model : ARV-112WT(U)

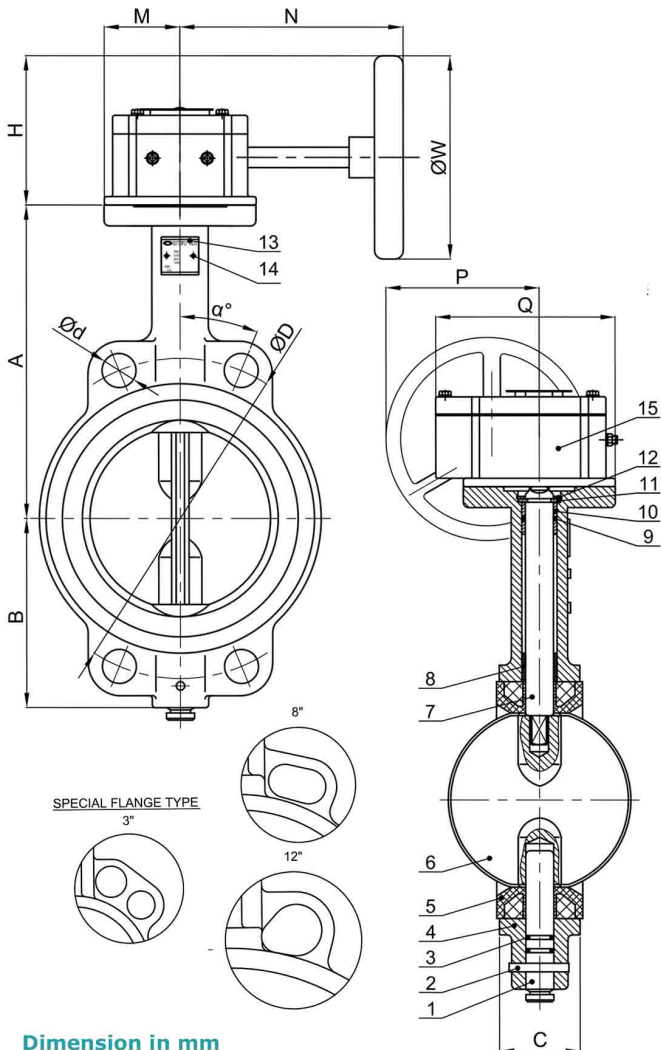

Design Standard

Design Standard	EN 593
Face to Face	EN 558
Flange Connection	Arita Universal Standard (include ANSI 150, JIS 10K, EN 1092 PN 10/16, AS 2129 Table E)
Test Standard	EN 12266-1

Hydrostatic Test

Pressure Rating	PN 10
Shell Test Pressure	1.5 Mpa
Seal Test Pressure	1.1 Mpa
Suitable Temperature	-20 to 180°C (PTFE)

Material

No	PART	MATERIAL
1	DOWN SHAFT	SS 420
2	LOCK PIN	SS 316
3	DOWN O-RING	VITON
4	BODY	SS 316
5	SEAT	PTFE
6	DISC	SS 316
7	UPPER SHAFT	SS 420
8	BUSHING (LONG)	PTFE
9	O-RING	VITON
10	BUSHING (SHORT)	PTFE
11	BESECT RING	SS 416
12	KEEPING RING	SPRING STEEL
13	NAME PLATE	ALUMINIUM
14	RIVET	ALUMINIUM
15	GEAR BOX	

Dimension in mm

DN	NPS	A	B	C	ØD	Ød	α°	H	ØW	M	N	P	Q
40	1.5"	136	65	32	Ø105.6	Ø23	45°	90	Ø120	45	155	100	108
50	2"	156	80	42.04	Ø120	Ø24	45°	90	Ø120	45	155	100	108
65	2.5"	162	89	45.68	Ø136.13	Ø28	45°	90	Ø120	45	155	100	108
80	3"	170	95	45.21	Ø154.5 Ø149.7	Ø24.5 Ø22	22.5° 45°	90	Ø120	45	155	100	108
100	4"	185	119	52.07	Ø182.5	Ø27	22.5°	90	Ø120	45	155	100	108
125	5"	207	127	55.36	Ø212.5	Ø25.5	22.5°	90	Ø120	45	155	100	108
150	6"	216	139	55.76	Ø238.12	Ø26	22.5°	90	Ø120	45	155	100	108
200	8"	256	175	60.58	Ø293 Ø296.07	Ø26 Ø27	15° 22.5°	138	Ø200	63	190	157	144
250	10"	248	203	67.63	Ø357	Ø30.5	15°	138	Ø200	63	190	157	144
300	12"	280	242	76.9	Ø400 Ø416.7	Ø25 Ø40.5	11.5° 15°	138	Ø200	63	190	157	144

The contents of this literature are for informative purposes only. Arita is not responsible for suitability or compatibility of these products in relation to system requirement. For specific requirements, consult Arita or its distributors. Arita reserves the right to change or modify product design without prior notice.

WAFER TYPE BUTTERFLY VALVE MULTIPLE FLANGED

Model : ARV-112WT(U)

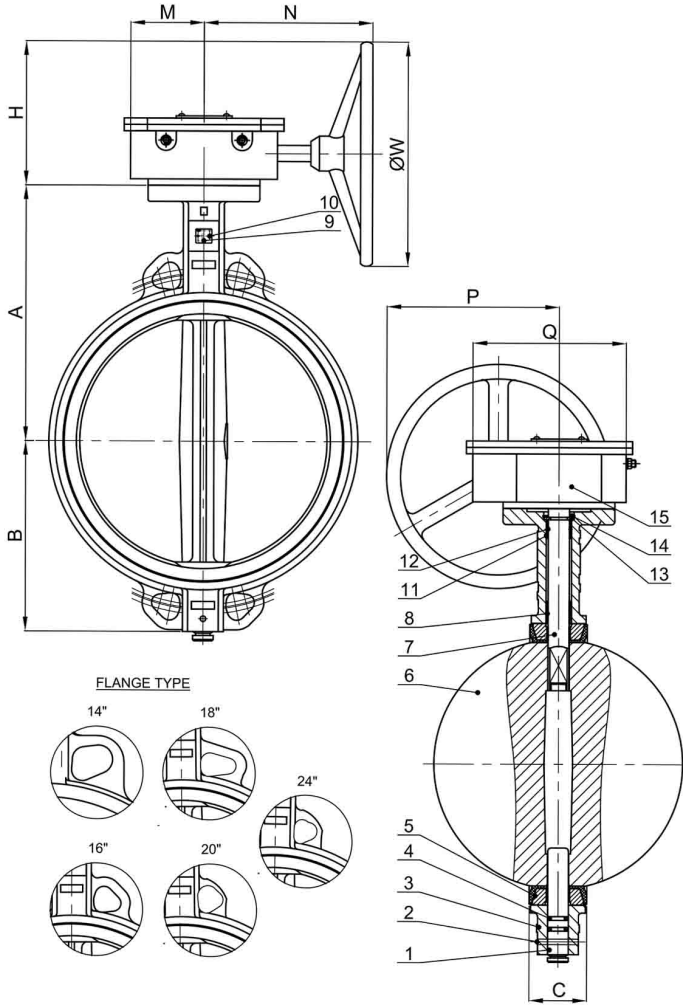

Design Standard

Design Standard	EN 593
Face to Face	EN 558
Flange Connection	Arita Universal Standard (include ANSI 150, JIS 10K, EN 1092 PN 10/16, AS 2129 Table E)
Test Standard	EN 12266-1

Hydrostatic Test

Pressure Rating	PN 10
Shell Test Pressure	1.5 Mpa
Seal Test Pressure	1.1 Mpa
Suitable Temperature	-20 to 180°C (PTFE)

Material

No	PART	MATERIAL
1	DOWN SHAFT	SS 420
2	LOCK PIN	SS 316
3	DOWN O-RING	VITON
4	BODY	SS 316
5	SEAT	PTFE
6	DISC	SS 316
7	UPPER SHAFT	SS 420
8	BUSHING (LONG)	PTFE
9	O-RING	VITON
10	BUSHING (SHORT)	PTFE
11	BESECT RING	SS 416
12	KEEPING RING	SPRING STEEL
13	NAME PLATE	ALUMINIUM
14	RIVET	ALUMINIUM
15	GEAR BOX	

Dimension in mm

DN	NPS	A	B	C	ØD	Ød	a°	H	ØW	M	N	P	Q
350	14"	368	267	75	Ø445 Ø470 Ø476.2	Ø25 Ø28 Ø26	11.25° 11.25° 15°	260	Ø400	125	320	323	260
400	16"	399	297	85.7	Ø521 Ø521 Ø525 Ø539.5	Ø27 Ø26 Ø31 Ø29	11.25° 11.25° 11.25° 11.25°	260	Ø400	125	320	323	260
450	18"	426	321	104.6	Ø525 Ø584 Ø585	Ø26 Ø27 Ø30	15° 9° 9°	260	Ø400	125	320	323	260
500	20"	481	358	130.28	Ø620 Ø641 Ø650	Ø27 Ø26 Ø33	9° 11.25° 9°	260	Ø400	125	320	323	260
600	24"	563	425	151.36	Ø725 Ø756 Ø770	Ø30 Ø33 Ø36	9° 11.25° 9°	290	Ø450	150	350	368	310

The contents of this literature are for informative purposes only. Arita is not responsible for suitability or compatibility of these products in relation to system requirement. For specific requirements, consult Arita or its distributors. Arita reserves the right to change or modify product design without prior notice.