



**ANGLE SEAT VALVE**  
(Single Acting)

**Product Features:**

There is automatic adjustable seal gland bush between overflow outlet and slide block.

The bevel structure have big flow rate, no water hammer, no noise and credible seal performance.



**Specification**

Orifice	: DN15-DN50
Thread	: G1/8" – G2"
Valve material	: stainless steel 316
Actuator material	: stainless steel
Valve core seal	: PTFE
Valve steam seal	: PTFE
Applicable medium	: Water, liquid, neutral gas, oil water steam, weak acid or weak alkalis solution.
Medium temperature	: -10°C ~ 180°C
Environment temperature	: -10°C ~ 60°C
Viscosity	: max 600 mm <sup>2</sup> /s
Installation	: any position
Controlling medium	: air or neutral gas
Controlling pressure range	: 0.3 ~ 1 MPa
Liquid working pressure	: 0 ~ 1.6 MPa

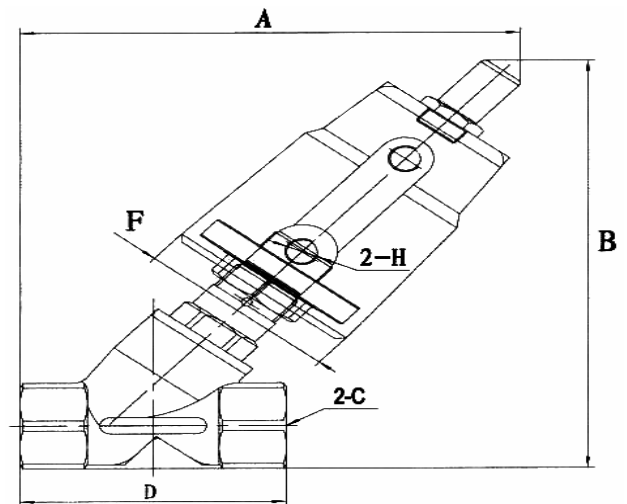
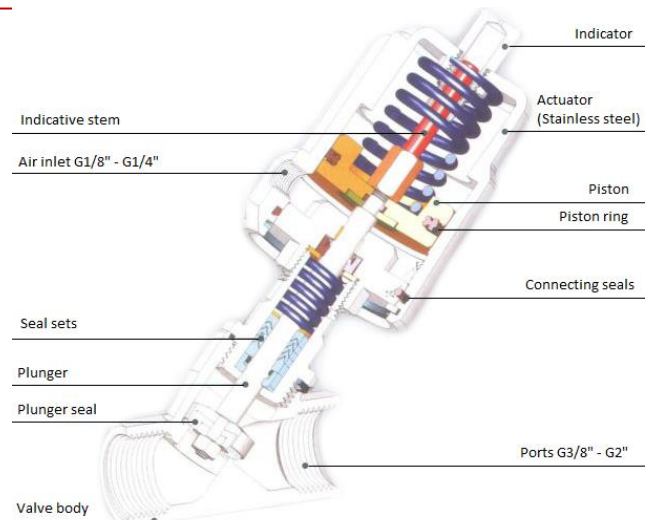

**Dimension Table**

Unit: (mm)

Model	Actuator Size	A	B	C	D	E	F	H
RJQ22S40-10	40	127.5	136	G3/8"	69	27	50	G1/8"
RJQ22S50-15	50	140	150	G1/2"	69	27	60.5	G1/8"
RJQ22S50-20	50	143	155	G3/4"	75.5	32	60.5	G1/8"
RJQ22S63-25	63	174.5	189.5	G1	90	39	77	G1/8"
RJQ22S63-32	63	190.5	207.5	G1-1/4"	117	50	77	G1/8"
RJQ22S63-40	63	190.5	207.5	G1-1/2"	117	55	77	G1/8"
RJQ22S63-50	63	219.5	232.5	G2"	145	70	77	G1/4"