



UNIMECH GROUP, MALAYSIA



A MEMBER OF UNIMECH GROUP, MALAYSIA

1000 W.O.G. REDUCE BORE ONE-PIECE BALL VALVE SCREWED END

ISO 9001 : 2000



The stainless steel body is a one piece compact design and is investment cast to provide high quality finishing and structural strength. It is also less prone to leak owing to its one piece body. There are options for ball seat materials, namely PTFE, RPTFE, PPL and PEEK that allow the valves to be employed in environments above 300°C. The ball and seats are of high finishing quality. This contributes to good sealing and low operating torque. Other features available are blowout proof stem and lockable handle. This product is suitable for general and industrial applications.

Dimension in mm

SIZES		ØD	L	H	A	h	Ø	WT. (KG)	Cv	TORQUE (Nm)
DN	In.									
6	1/4	5.0	39	33	69	17.0	10.0	0.07	3.7	1.2
10	3/8	7.0	44	35	91	21.0	13.2	0.10	4.0	1.2
15	1/2	9.2	57	40	93	24.5	15.5	0.15	4.5	1.3
20	3/4	12.5	59	44	93	32.0	20.5	0.26	9.0	1.2
25	1	15.0	71	51	111	38.0	25.5	0.41	16.0	3.9
32	1 1/4	20.0	78	57	111	47.8	32.0	0.63	24.0	7.0
40	1 1/2	25.0	83	64	139	52.8	39.0	0.76	37.0	6.8
50	2	32.0	100	70	139	64.5	50.0	1.23	68.0	9.6
65	2 1/2	38.0	128	85	187	82.5	60.0	2.88	80.0	15.0
80	3	50.0	153	90	187	96.0	76.5	4.21	148.0	32.0

Note : Cv = US Gallon per minutes

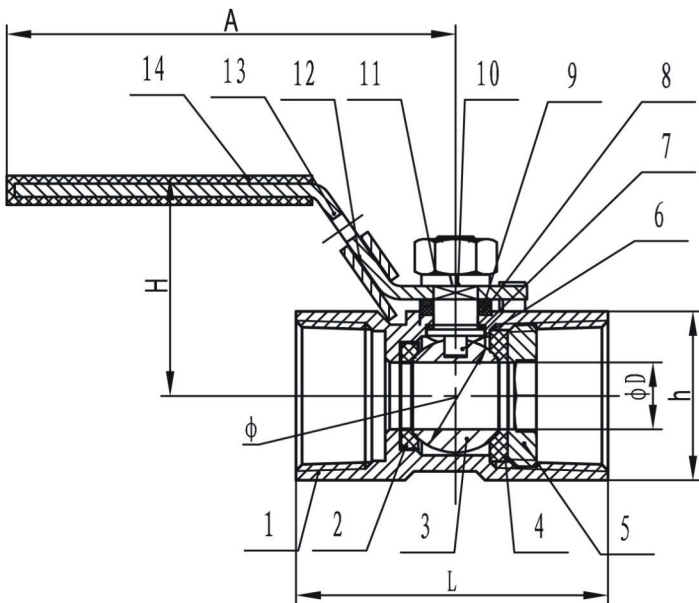

Material

No.	PART	QTY.	MATERIAL
1	BODY	1	CF8 / CF8M / WCB
2	SEAT (a)	1	RPTFE / PTFE / PPL / PEEK
3	BALL	1	SUS 304 / 316
4	SEAT (b)	1	RPTFE / PTFE / PPL / PEEK
5	BODY INSERT	1	CF8 / CF8M / WCB
6	STEM	1	SUS 304 / 316
7	THRUST WASHER	1	RPTFE / PTFE
8	STEM PACKING	1	RPTFE / PTFE
9	SPACE WASHER	1	SUS 304 / 316
10	SPRING WASHER	1	SUS 304 / 316
11	HANDLE NUT	1	SUS 304 / 316
12	LOCKING DEVICE	1	SUS 304 / 316
13	HANDLE	1	SUS 304 / 316
14	PLASTIC COVER	1	PLASTIC

* PTFE -120°C RPTFE -200°C PPL -300°C PEEK -350°C

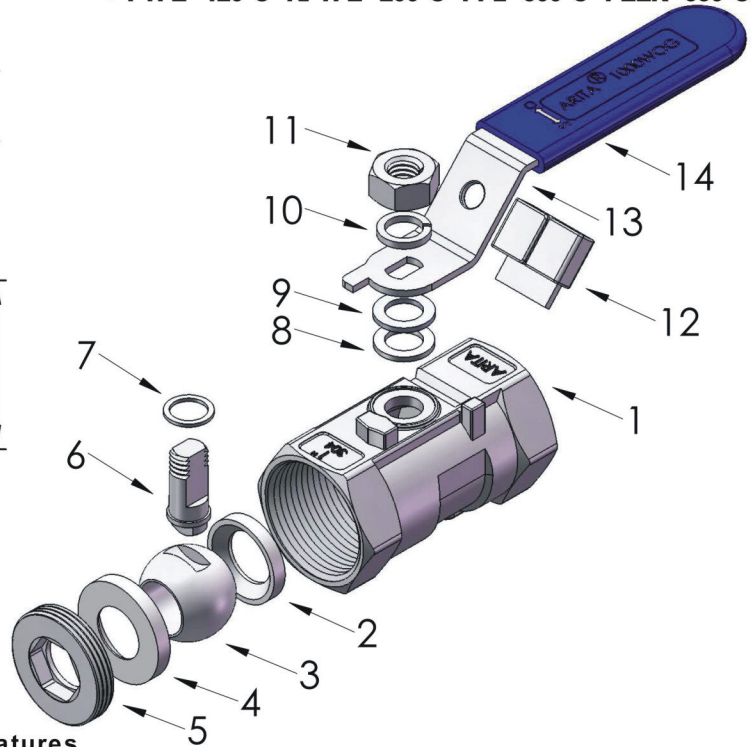

Features

- * Pipe thread in accordance : NPT, BSP, BSPT, DIN259, DIN299, ISO 228 CLASS A
- * Screwed end
- * Blow-out proof stem / Reduce Bore
- * Investment casting body
- * 1000psi (69 Bar) W. O. G. / PN63
- * Locking device
- * Wall thickness ASME B16.34
- * Material : S45C / ASTM A216Gr-WCB / DIN 1. 0619
SS304 / ASTM A351Gr-CF8 / DIN 1. 4308
SS316 / ASTM A351Gr-CF8M/ DIN 1. 4408

