

Dimension In mm (DIN2501 PN10/16 ; EN1092-2 PN10/16)

SIZES		A	B	C	ØD1	ØD2		N x M		a°		ØE1	n x ØE2	ØE3	ØE4	TORQUE (Nm)		Cv	WT. (KG)
DN	In.					PN 10	PN 16	PN 10	PN 16	PN 10	PN 16					PN 10	PN 16		
50	2	241	161	42.0	52.9	125	125	4 x M16	4 x M16	45.00	45.00	50	4 x Ø7	65	35	14	15	29	3.3
65	2 1/2	264	175	44.7	64.5	145	145	4 x M16	4 x M16	45.00	45.00	50	4 x Ø7	65	35	15	17	53	3.3
80	3	276	181	45.2	78.8	160	160	8 x M16	8 x M16	22.50	22.50	50	4 x Ø7	65	35	22	23	82	4.3
100	4	314	200	52.1	104.1	180	180	8 x M16	8 x M16	22.50	22.50	70	4 x Ø10	90	55	37	40	129	5.0
125	5	340	213	54.4	123.3	210	210	8 x M16	8 x M16	22.50	22.50	70	4 x Ø10	90	55	58	62	210	7.4
150	6	365	226	55.8	155.6	240	240	8 x M20	8 x M20	22.50	22.50	70	4 x Ø10	90	55	94	102	304	8.9
200	8	435	260	60.6	202.5	295	295	8 x M20	12 x M20	22.50	15.00	102	4 x Ø12	125	70	174	192	537	14.7
250	10	495	292	65.6	250.5	350	355	12 x M20	12 x M24	15.00	15.00	102	4 x Ø12	125	70	286	323	782	26.8
300	12	579	337	76.9	301.6	400	410	12 x M20	12 x M24	15.00	15.00	102	4 x Ø12	125	70	429	490	1161	40.0
350	14	635	368	75.0	333.5	460	470	16 x M20	16 x M24	11.25	11.25	102	4 x Ø12	125	70	550	625	1564	56.0

Note : Cv = US Gallon per minutes

Pressure Test

Working Pressure	1.0 MPa	1.6 MPa	10K	ANSI 125		ANSI 150
SIZE	2"-40"	2"-24"		2"-12"	14"-24"	2"-12"
Hydrostatic Test	Seal: 1.1 MPa Body: 1.5 MPa	1.76 MPa 2.4 MPa	1.54 MPa 2.1 MPa	1.52 MPa 2.1 MPa	1.14 MPa 1.55 MPa	2.2 MPa 3.0 MPa

Working Temperature

Temperature °C	-10 ~ 80	-15 ~ 140	-20 ~ 150	-20 ~ 180
Seat Material	NBR	EPDM	VITON	PTFE

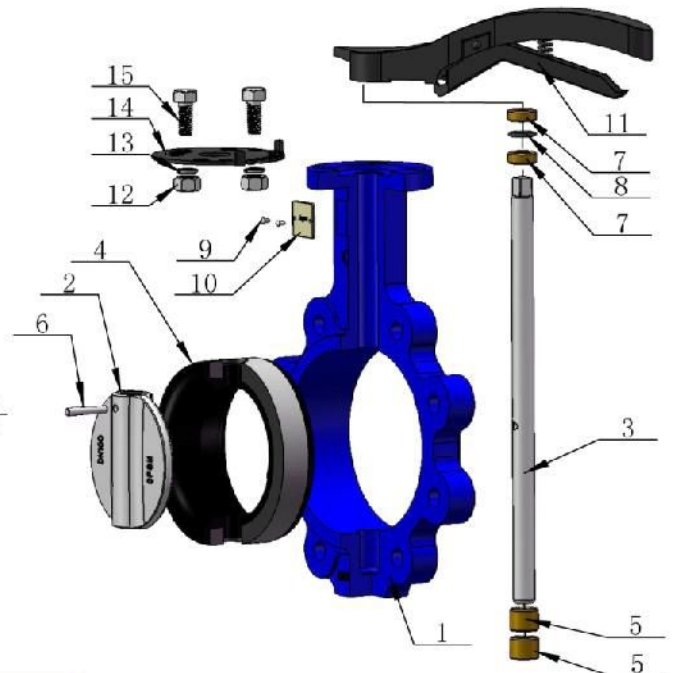
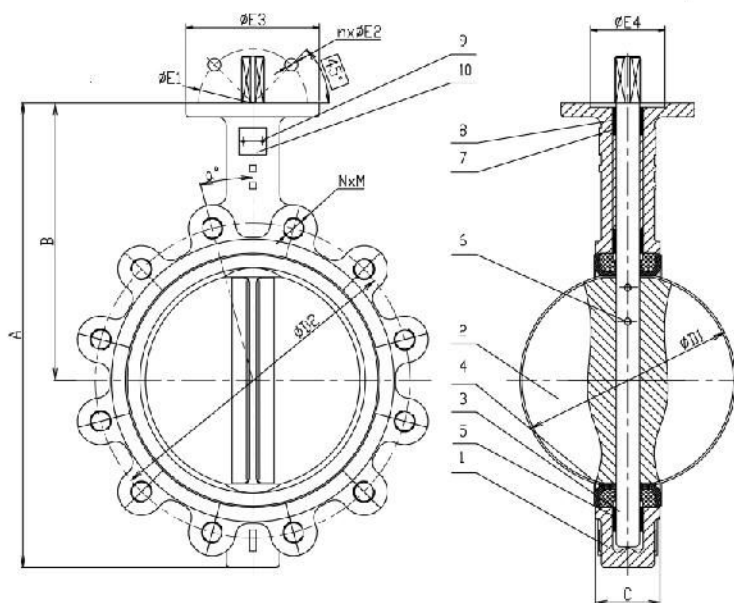

Materials

No.	PART	QTY.	MATERIAL
1	BODY	1	GG-20 / GGG-40
2	DISC	1	DUCTILE IRON/COATING NYLON/PTFE/NICKEL BRONZE/G-X6CrNi18-9/G-X6CrNiMo18-10/POLISHED
3	STEM	1	X12CrS13 / X5CrNiMo17-12-2
4	SEAT	1	PTFE / NBR / EPDM / VITON
5	BUSHING	2	PTFE
6	PIN	1-3	X12CrS13 / X5CrNiMo17-12-2
7	BUSHING	2	PTFE
8	'O' RING	1	NBR / EPDM / VITON
9	RIVET	2	ALUMINIUM
10	NAMEPLATE	1	ALUMINIUM
11	HANDLE	1	EPOXY COATING / DUCTILE IRON
12	NUT	2	CARBON STEEL
13	SPRING WASHER	2	SPRING STEEL
14	INDICATOR	1	ELECTRO-PLATING / EPOXY COATING
15	WASHER	2	CARBON STEEL
16	BOLT	2	CARBON STEEL

Standard:

Design Standard	: BS EN593
Face to Face	: BS EN558-1 / ISO5752 / JIS B2002
Flange Connection	: EN1092-2 PN10/16 ; DIN2501 PN10/16 ; BS4504 PN10/16.
Top Flange	: ISO 5211
Test Standard	: BS EN12266-1 / API 598

The contents of this literature are for informative purposes only. Arita is not responsible for suitability or compatibility of these products in relation to system requirement. For specific requirements, consult Arita or its distributors. Arita reserves the right to change or modify product design without prior notice.

